

RESIDENTIAL BUILDING PERMIT REQUIREMENTS

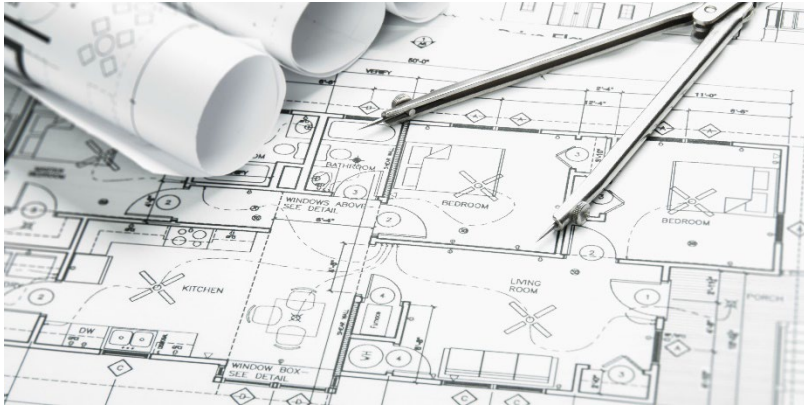

BUILDING PERMITS ARE REQUIRED FOR THE FOLLOWING PROJECTS:

- ❖ Accessory buildings/sheds over 200 sq. ft
- ❖ Air Conditioning Units
- ❖ Any deck with attached roofs
- ❖ Attached/Detached Garages
- ❖ Basement Finishes
- ❖ Decks over 30" above ground level and/or greater than 200 sq. ft.
- ❖ Electric to gas conversions
- ❖ Evaporative/Swamp Coolers
- ❖ Fences over 42" tall
- ❖ Fireplaces (wood, pellet, or gas), firepits
- ❖ Furnace installation or replacement
- ❖ Gas lines and gas repairs
- ❖ Increase/decrease in window/door size
- ❖ Installation of additional windows/doors
- ❖ Lawn sprinklers (backflow preventer only)
- ❖ Patio covers, awnings, carports, and enclosures
- ❖ Plumbing Modifications
- ❖ Pools, hot tubs, and spas
- ❖ Retaining walls over 24" from bottom of footing (engineering required over 48")
- ❖ Remodeling
- ❖ Roofing/Reroofing
- ❖ Room Additions
- ❖ Siding and Stucco
- ❖ Structural Modifications

BUILDING PERMITS NOT REQUIRED FOR THE FOLLOWING PROJECTS:

- ❖ Adding insulation (if not conditioning building/structure)
- ❖ Concrete porches (without roofs)
- ❖ Fences less than 42" tall
- ❖ Flooring wallpaper
- ❖ Freestanding decks not more than 30" above ground level and 200 sq. ft. or less
- ❖ General landscaping
- ❖ Minor fence picket repair
- ❖ Minor roofing repair (1 sq or less)
- ❖ Painting
- ❖ Retaining walls 24" or less from bottom of footing
- ❖ Replacing cabinets and counter tops
- ❖ Replacing plumbing fixtures
- ❖ Replacing windows and doors (same size)
- ❖ Storage sheds/gazebos 200 sq. ft. or less

If you do not see your specific project listed, please contact the Building Safety team at **720.523.6800** or epermitcenter@adcogov.org for more information regarding your project. Informational handouts are available in the Adams County Government Center, and online at epermits.adcogov.org

